

HOUSE TYPE **A** 2 BEDROOM BUNGALOW  
Total Area - 62.9 sq. MT. / 676 sq. FT.

HOUSE TYPE **C** 3 BEDROOM 2 STOREY UNIT  
Total Area - 104.8 sq. MT. / 1126 sq. FT.

HOUSE TYPES **A+C**



Ground Floor A

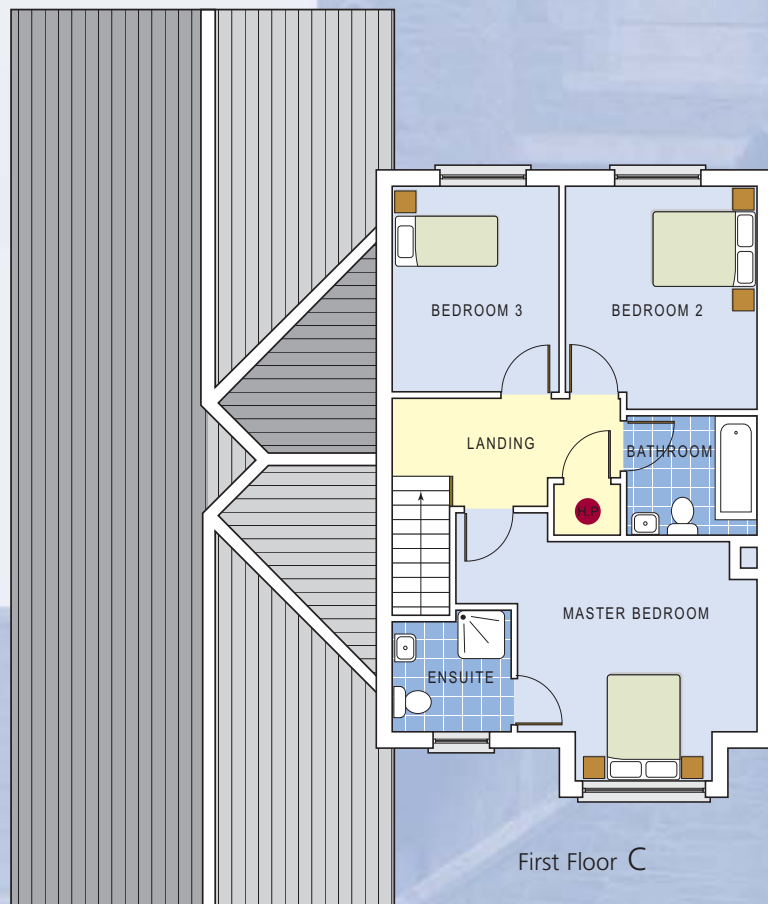

First Floor C